

McKissick® AISE Roll Forged Sheaves

McKissick® manufactures special "Roll Forged"™ Sheaves to meet the Specifications of AISE Standard Number 6.

- AISE Sheaves must meet specified criteria established by the Association of Iron and Steel Engineers for special use in electric overhead Traveling Cranes for Steel Mill Service.
- Other typical applications that may specify AISE sheaves:
 - Mobile Cranes
 - Portal Cranes
 - Power Shovels
 - Other equipment using wire rope

Typical AISE Sheave Rim Profile with Specified Dimensional Requirements

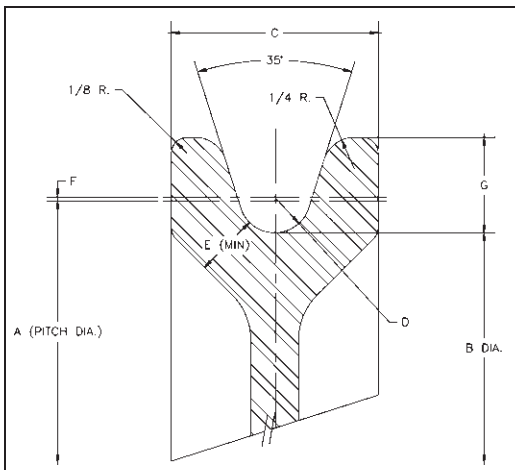

Sheave Wheel Contours							
Rope Diameter* (mm)	Dimensions (mm)						
	A	B	C	D	E	F	G
13	381	368	44.5	7.1	12.7	0.8	19.1
16	476	461	51.0	8.7	16.0	0.8	23.8
19	572	552	57.0	10.3	19.1	0.8	28.6
22	667	645	63.5	12.3	22.2	1.2	33.4
25	762	737	70.0	13.9	25.4	1.2	38.1
28	857	829	76.0	15.4	28.6	1.2	42.9
32	953	921	82.5	17.5	31.8	1.6	47.6
35	1048	1013	89.0	19.1	34.9	1.6	52.5
38	1143	1105	95.5	20.6	38.1	1.6	57.0

* Sheaves with other wireline sizes are available upon request. Other pitch diameters available on application basis. Grooves are flame hardened to min. RC35 for 13mm wire line and larger.

For additional information concerning special AISE sheaves, contact:

In U.S.A. - Crosby's Special Engineered Product Group at 1-800-777-1555

In Canada - Crosby Canada at (905) 451-9261

In Europe - N.V. Crosby Europe at 32-15-757125