

Pear Shaped Links



A-341



- Alloy Steel - Quenched and Tempered
- Individually Proof Tested at 2 times Working Load Limit with certification.
- Proof Test certification shipped with each link.
- Sizes 13mm, 16mm, 19mm, 22mm, 25mm, 32mm and 35mm are drop forged.

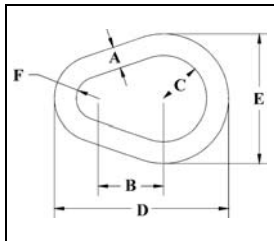

A-341 Alloy Pear Shaped Links

Stock Size (A) (mm)	A-341 Stock No.	Working Load Limit		Weight Each (kg)	Dimensions (mm)				
		(t)*	(lbs.)		B	C	D	E	F
13	1013575	3.15	7000	.25	38.1	25.4	102	76.2	12.7
16	1013584	4.09	9000	.50	47.8	31.8	127	95.3	16.0
19	1013595	5.59	12300	.80	57.0	38.1	152	114	19.1
22	1013604	6.81	15000	1.28	67.0	44.5	178	133	22.4
25	1013613	11.0	24360	1.91	76.0	51.0	203	152	25.4
†† 28	1013622	13.9	30600	2.83	86.0	57.0	222	171	28.7
32	1013631	16.4	36000	3.74	102	63.5	254	191	31.8
35	1013640	19.5	43000	5.10	105	70.0	279	210	35.1
†† 38	1013649	24.7	54300	6.46	114	76.0	305	229	38.1
†† 42	1013658	28.4	62600	8.39	124	82.5	330	248	41.4
†† 44	1013667	38.6	84900	10.2	133	89.0	356	267	44.5
†† 48	1013676	43.5	95800	13.2	143	95.5	381	286	47.8
†† 51	1013685	46.6	102600	15.4	152	102	406	305	51.0
†† 57	1013694	65.0	143100	21.8	171	114	457	343	57.0
†† 64	1013703	66.9	147300	29.9	191	127	508	381	63.5
†† 70	1013712	98.6	216900	39.9	210	140	559	419	70.0
†† 76	1013721	103	228000	52	229	152	610	457	76.0
†† 83	1013730	119	262200	66	248	165	660	495	82.5
†† 89	1013739	126	279000	82	267	178	711	533	89.0
†† 102	1013748	169	373000	123	305	203	813	610	102

* Based on single leg sling (in-line load), or resultant load on multiple legs with an included angle less than or equal to 120°. Minimum Ultimate load is 5 times the Working Load Limit.
 †† Welded Link.

G-341 / S-341



- Forged carbon steel - Quenched and Tempered.
- Self Colored or Hot Dip galvanized.

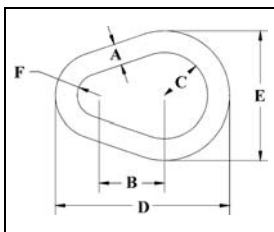

G-341 S-341 Weldless Sling Links

Size (A) (mm)	Stock No.		Working Load Limit Single Pull (t)*	Weight Each (kg)	Dimensions (mm)				
	G-341 Galv.	S-341 S.C.			B	C	D	E	F
10	1013897	1013904	.82	0.10	28.7	19.1	76.0	57.0	9.65
13	1013913	1013922	1.32	.25	38.1	25.4	102	76.0	12.7
16	1013931	1013940	1.91	.48	47.5	31.8	127	95.5	16.0
19	1013959	1013968	2.72	.85	57.0	38.1	152	114	19.1
22	1013977	1013986	3.76	1.25	67.0	44.5	178	133	22.4
25	1013995	1014002	4.90	1.97	76.0	51.0	203	152	25.4
32	1014011	1014020	7.60	3.45	102	63.5	260	191	31.8
35	1014039	1014048	9.30	5.13	105	70.0	279	210	35.1

* Ultimate Load is 6 times the Working Load Limit. Based on single leg sling (in-line load), or resultant load on multiple legs with an included angle less than or equal to 120°.