

# Button Spelter Sockets

## SB-427

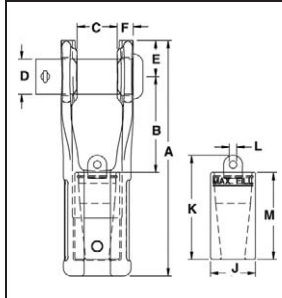

- Available in six sizes from 13mm to 38mm.
- Button Spelter terminations have a 100% efficiency rating, based on the catalog strength of the wire rope.
- Designed for use with mobile cranes. Can be used to terminate high performance, rotation resistant ropes, and standard 6 strand ropes.
- Easy to install assembly utilizes Crosby® WIRELOCK® socketing compound.
- Sockets and buttons are re-usable.
- Replacement buttons and sockets are available.
- Locking feature available to prevent rotation of rope.
- Button contains cap with eye that can be attached to, and used to pull, rope during reeving process.



## Button Spelter Sockets

| Wire Rope Size |               | SB-427 Stock No. | Weight Each (kg) | Socket Only Stock No. | Button Only Stock No. | Dimensions (mm) |     |    |    |    |    |    |     |    |     |  |
|----------------|---------------|------------------|------------------|-----------------------|-----------------------|-----------------|-----|----|----|----|----|----|-----|----|-----|--|
| (mm)           | (in.)         |                  |                  |                       |                       | A               | B   | C  | D  | E  | F  | J  | K   | L  | M   |  |
| 13-16          | 1/2 - 5/8     | 1052005          | 2.76             | 1052107               | 1052309               | 202             | 82  | 33 | 30 | 31 | 14 | 38 | 89  | 6  | 74  |  |
| 16-19          | 5/8 - 3/4     | 1052014          | 4.67             | 1052116               | 1052318               | 240             | 99  | 39 | 35 | 37 | 17 | 44 | 109 | 10 | 87  |  |
| 19-22          | 3/4 - 7/8     | 1052023          | 7.75             | 1052125               | 1052327               | 275             | 112 | 45 | 41 | 43 | 19 | 52 | 121 | 10 | 101 |  |
| 22-26          | 7/8 - 1       | 1052032          | 13.24            | 1052134               | 1052336               | 327             | 139 | 52 | 51 | 51 | 23 | 62 | 143 | 16 | 115 |  |
| 28-32          | 1-1/8 - 1-1/4 | 1052041          | 20.86            | 1052143               | 1052345               | 378             | 144 | 64 | 57 | 64 | 28 | 75 | 180 | 19 | 145 |  |
| 35-38          | 1-3/8 - 1-1/2 | 1052050          | 35.38            | 1052152               | 1052354               | 459             | 182 | 77 | 70 | 70 | 31 | 92 | 205 | 19 | 172 |  |

## Wirelock Requirements

| Wire Rope Size |               | WIRELOCK Required (cc) | WIRELOCK Stock No. | WIRELOCK Kit Size (cc) |
|----------------|---------------|------------------------|--------------------|------------------------|
| (mm)           | (in.)         |                        |                    |                        |
| 13-16          | 1/2 - 5/8     | 35                     | 1039602            | 100                    |
| 16-19          | 5/8 - 3/4     | 60                     | 1039602            | 100                    |
| 19-22          | 3/4 - 7/8     | 100                    | 1039602            | 100                    |
| 22-26          | 7/8 - 1       | 140                    | 1039602 *          | 100                    |
| 28-32          | 1-1/8 - 1-1/4 | 250                    | 1039604            | 250                    |
| 35-38          | 1-3/8 - 1-1/2 | 420                    | 1039606            | 500                    |

\* 2 kits required.